

Ready Mixed Concrete Safety Hand Signals

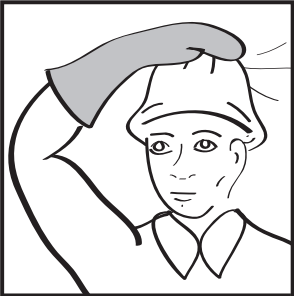

Drive In
Conduzca Adentro

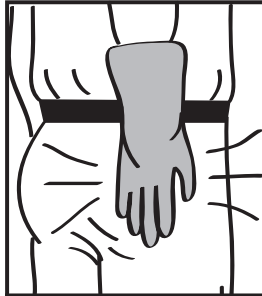

Back In
Dale en Reversa

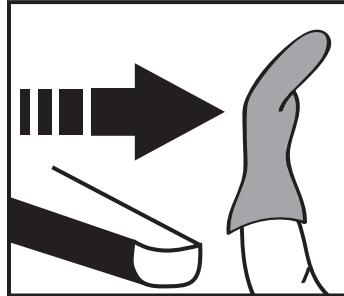

Back Up
Conduzca Hacia Atrás

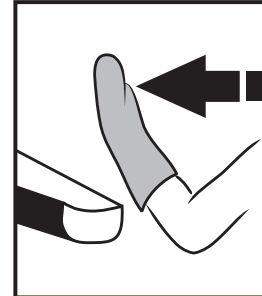

Pull Forward
Adelántese

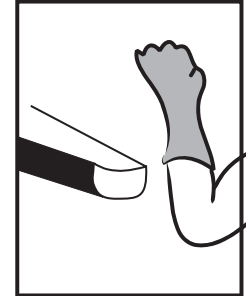

Stop
Alto

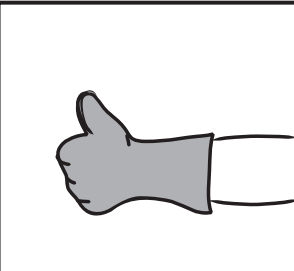

Raise Chute
Levante el Canal
Inclinado

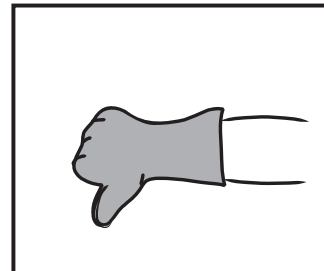

Lower Chute
Baje el Canal
Inclinado

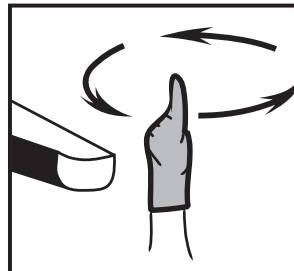

Start Pouring
Empiece a Vaciar



More Water
Más Agua

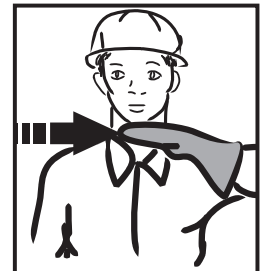

Stop Pouring
Pare de Vaciar